



# DUMPSTATION

## FENV906.0000

REGISTERED DESIGN 202116495

### Installation & Usage Instructions

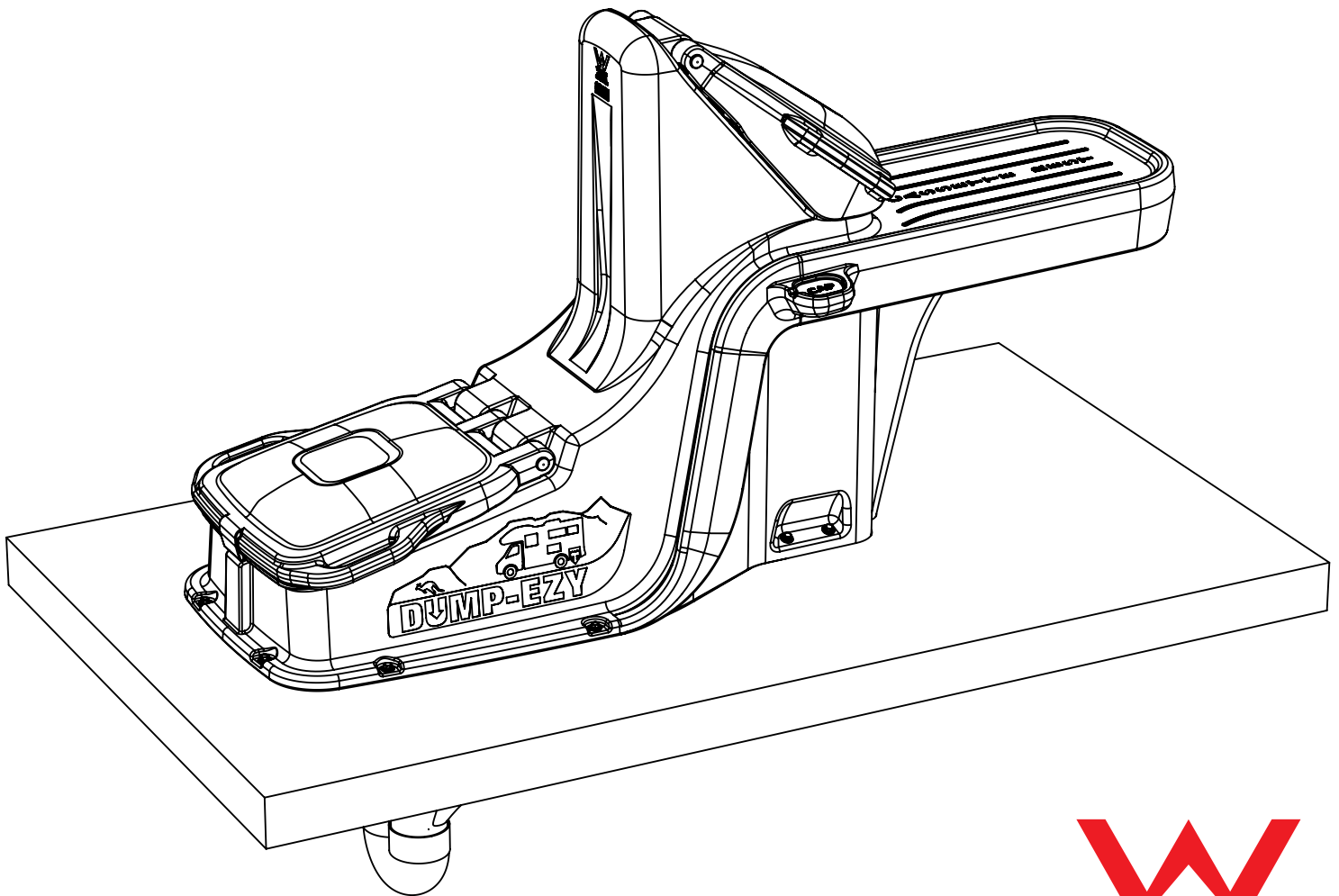

**WaterMark**

WMTS - 482

Lic WMKT 21102

**GOUGH**  
**PLASTICS**

# Standard Inclusions

**Rubber O-Ring Seal**  
supplied with Dump Station

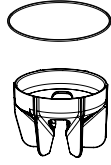

**\*150mm Rubbish Block**  
supplied with Dump Station  
\*Fit down inside the  
150mm L.I.T

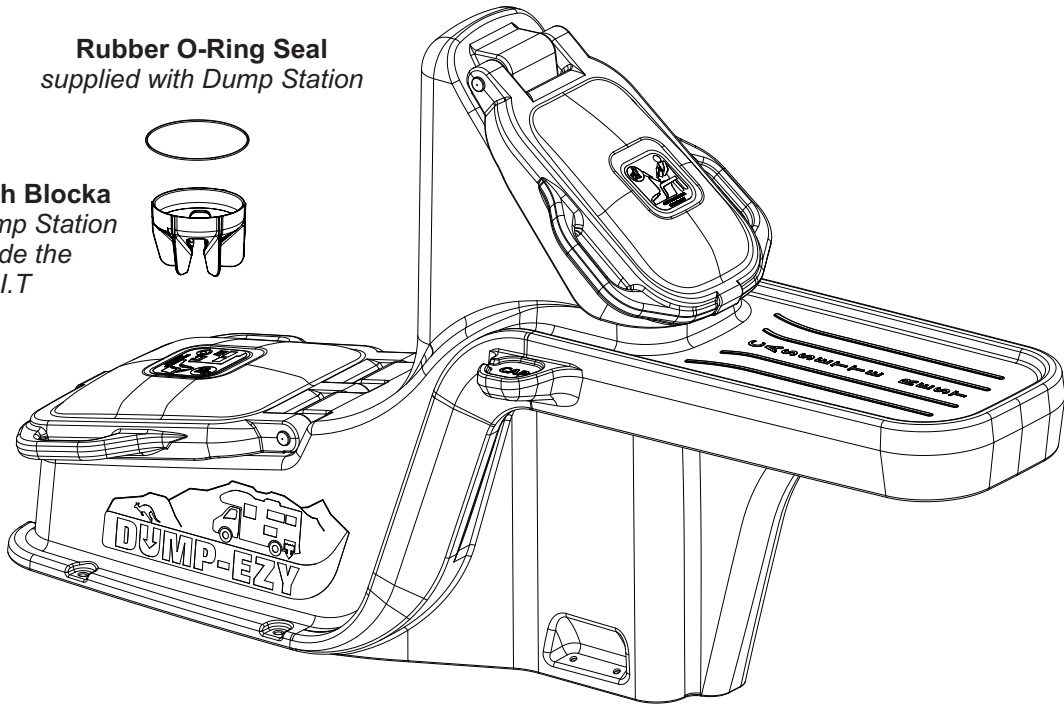

## Required for installation: (Not Supplied)

- 100mm PVC-U DWV Pipe** - Qty 2m min.
- Stainless Fasteners** - M10 x 90mm Concrete Anka Screws - Stainless - Qty 10  
- M12 Round Washers (24mm approx dia.) - Stainless - Qty 10  
*NB: M12 Washers req'd to fit M10 Concrete Anka Screws*
- PVC Pipe Cement**
- Sewer Plumbing Kit** - (Can be purchased from Dump Station Supplier, as per below)

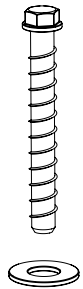

### Sewer Plumbing Kit (Can be purchased from Dump Station supplier)

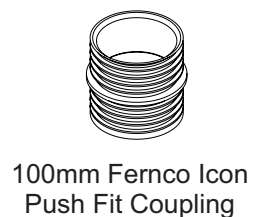
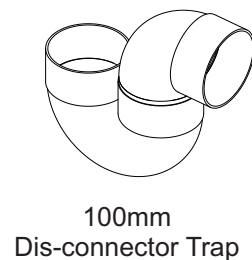
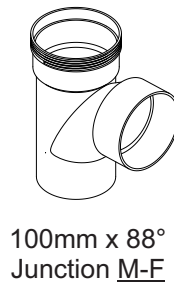
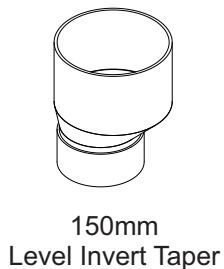
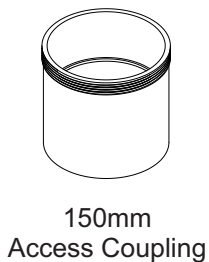

# Installation Guidelines

## Installation

All installations should comply with AS/NZS 3500.2 Section 3.15

## Site Location

When selecting a site to install the Dump-ezy consideration should be given to traffic in and around the area. Consideration should be given to any nearby features such as toilet blocks, tables, play grounds etc. Side access roads / isolated pull over bays are ideal.

## Barriers

Physical barriers such as concrete kerbing, metal railings, treated pine stumps etc can help prevent vehicles and similar from coming in contact with the Dump-ezy. These should be positioned in a way that still allows clear access for persons and hoses / cartridges.

## Signage

Adequate signage should also be installed to make people visibly aware of the Dump-ezy. Talk to your sales representative.

## Hose Wash Down

A tap and hose should be provided next to installations to enable wash down with each use.

This ensures a nice clean unit is maintained.

Note: If a back-flow prevention device is installed on the hose cock it will require inspection and certification under AS 3500.

## Drainage

Adequate drainage should be provided in and around the Dump-ezy to prevent infiltration from high rainfall, runoff etc.

## Pipework and Fittings

Pipework and fittings should be checked as per standard plumbing guidelines.

Fittings should be inspected for leaks at joints and tank connections.

**Important**  Install the Dump Station lower than vehicle outlet height shown so waste can drain through hose via gravity.

 For compliance with Plumbing Standard AS/NZS 3500.2 the minimum height of the front edge of the low basin must be at least 150mm above ground level. (This is to prevent inflow of ground water into the sewer)

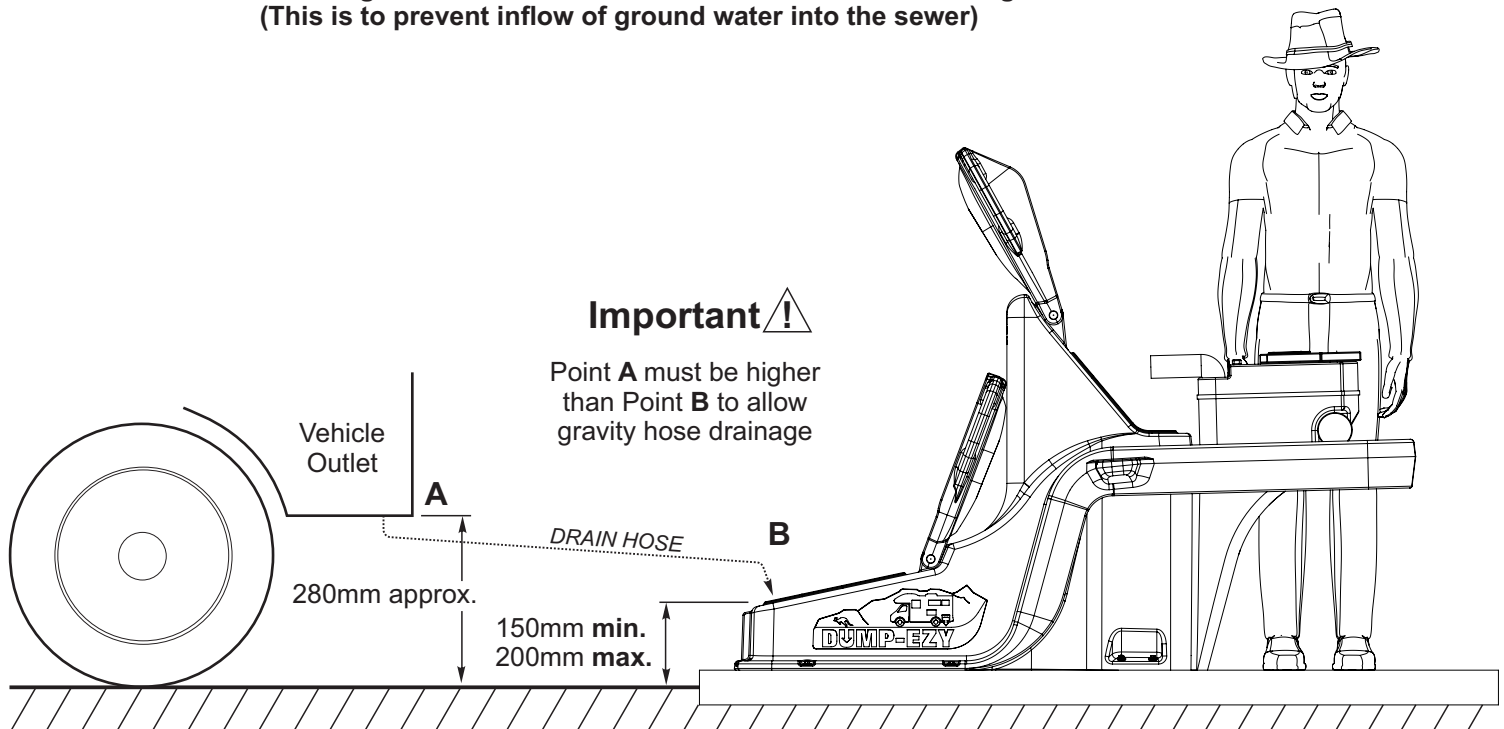

## Site Location (Guide Only)

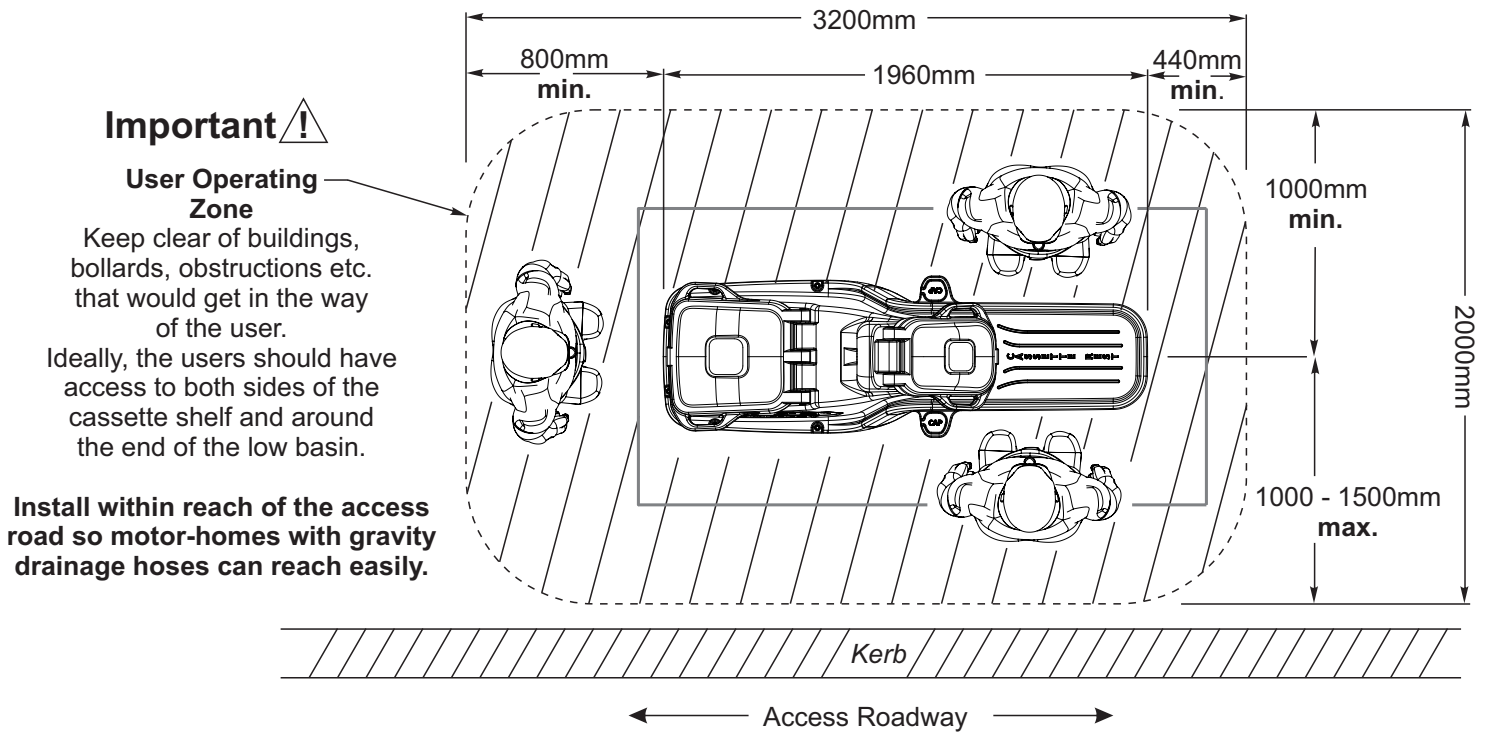

e.g Parallel to Roadway

e.g Perpendicular to Roadway

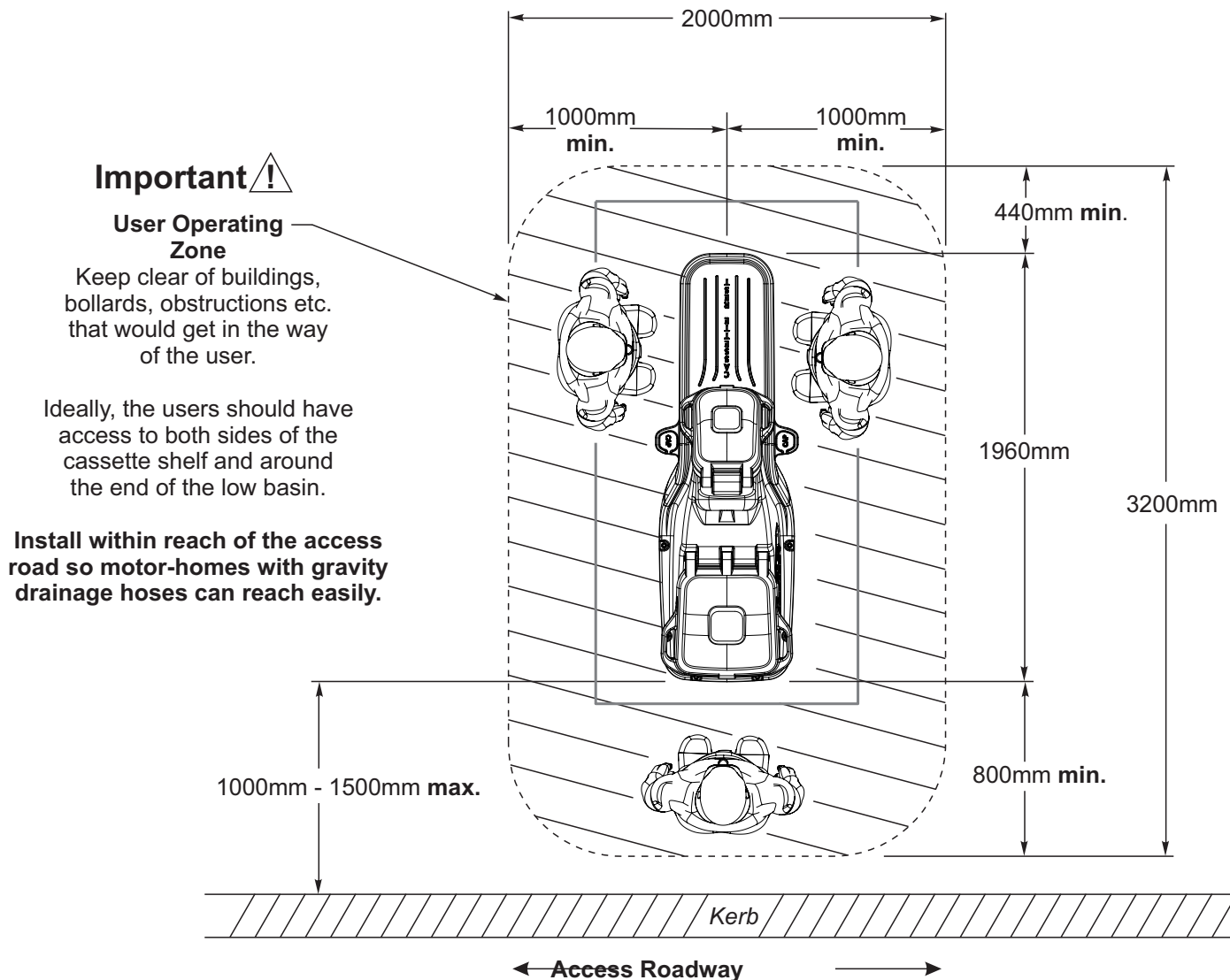

# Plumbing & Concrete Slab Set-up - Option A

## Single trap

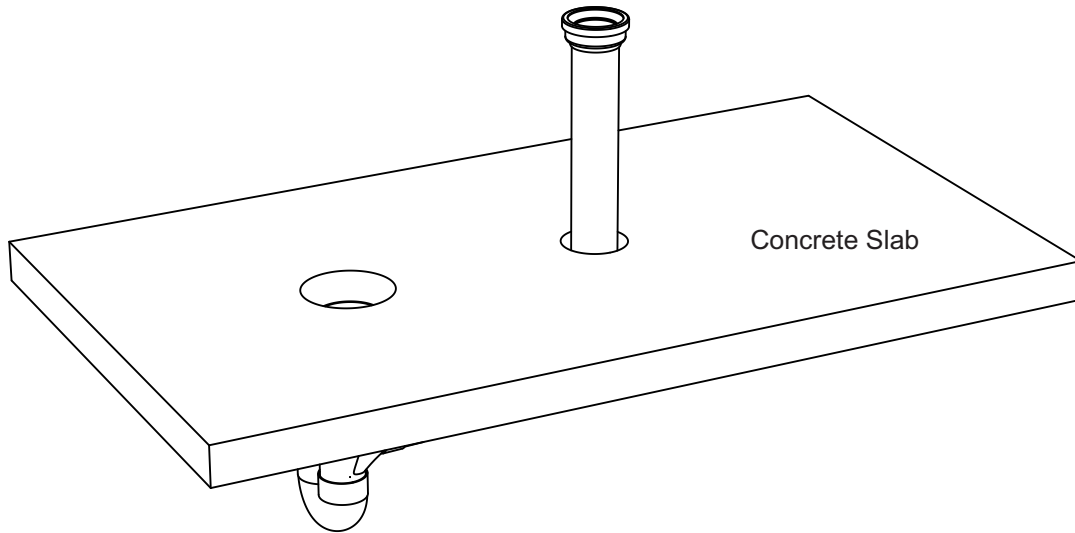

**Important**

All Plumbing & Installation shall be in accordance with AS/NZS 3500.2 Sanitary Plumbing and Drainage Standard

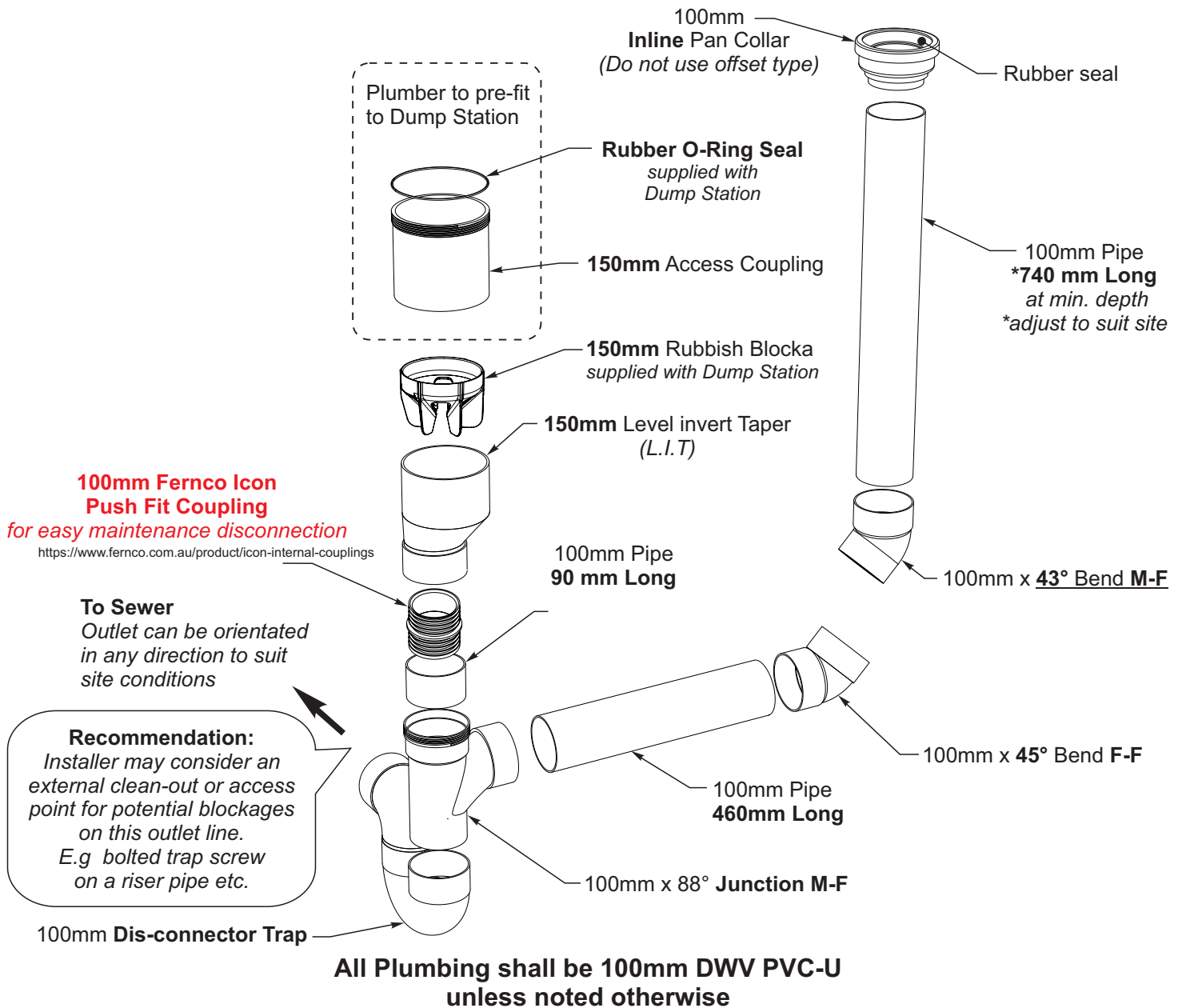

# Plumbing & Concrete Slab Set-up - Single trap (depth permitting)

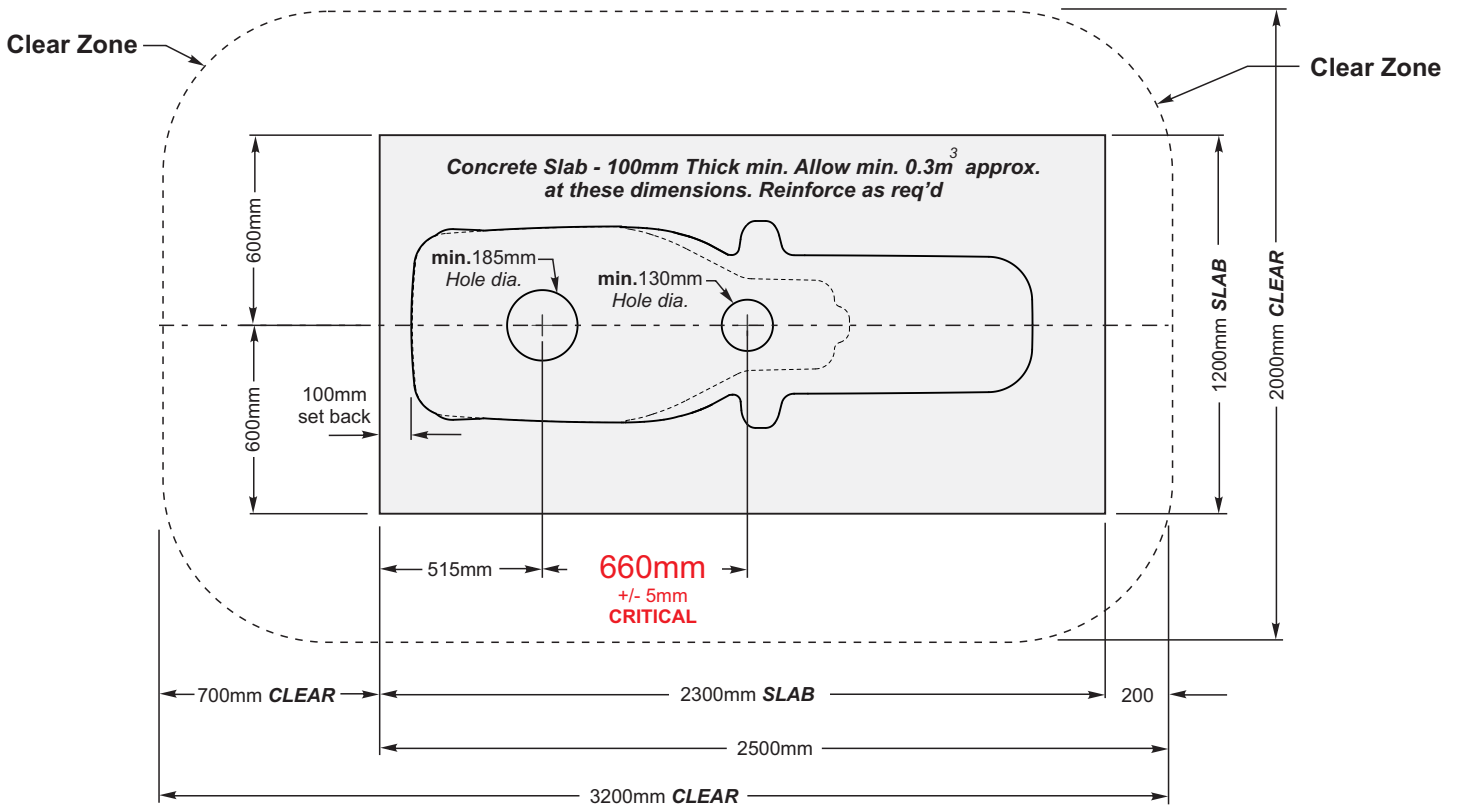

**Top View**

**Very Important** !

Form an oversized hole in the concrete around the Lever Invert Taper leaving clearance for the 150mm coupling to fit down the outside when the Dump Station is lowered into position. E.g wrap foam tape or a larger pipe offcut etc to form gap from concrete.

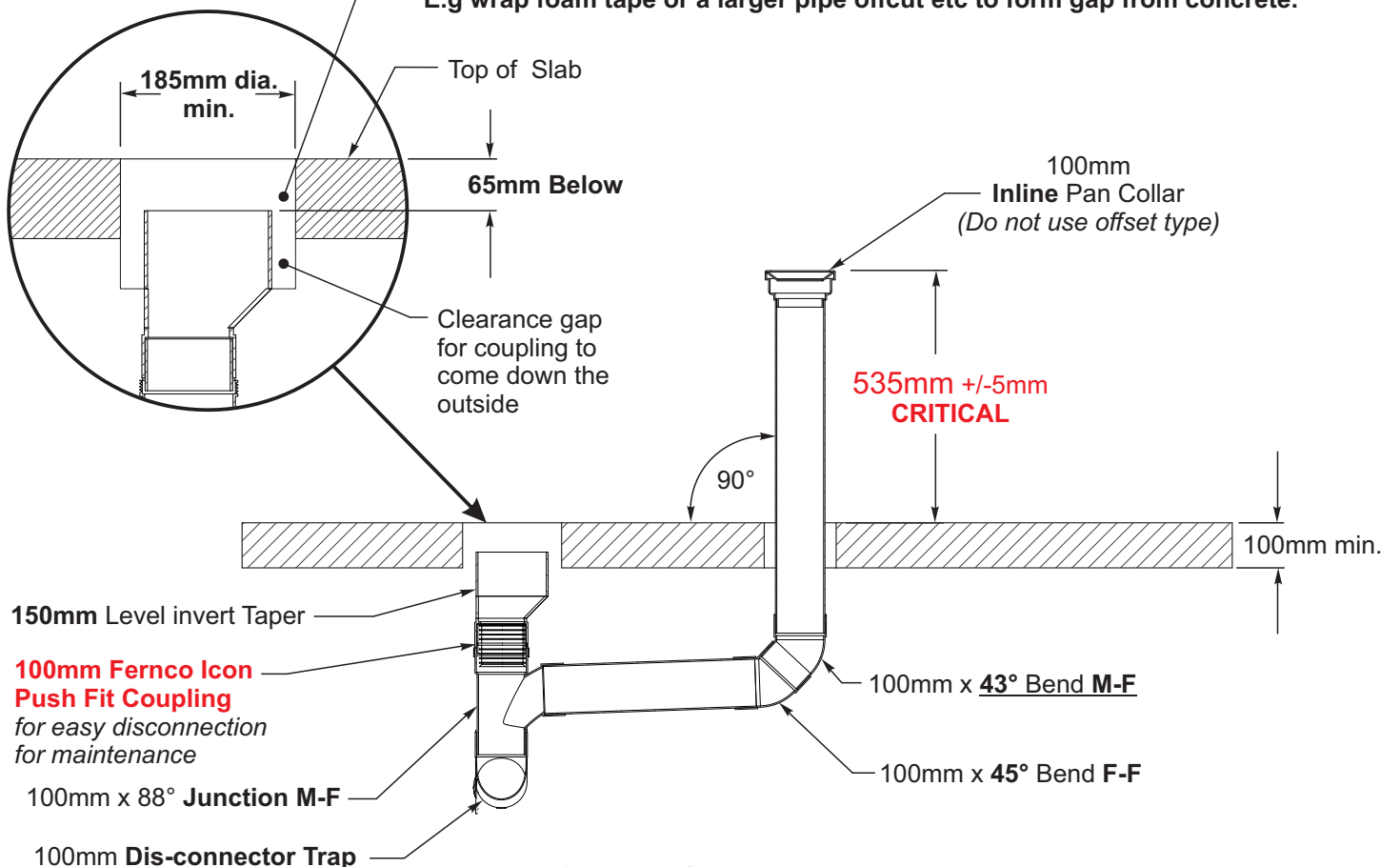

**Cross Section**

# Plumbing & Concrete Slab Set-up - Option B

## Double trap

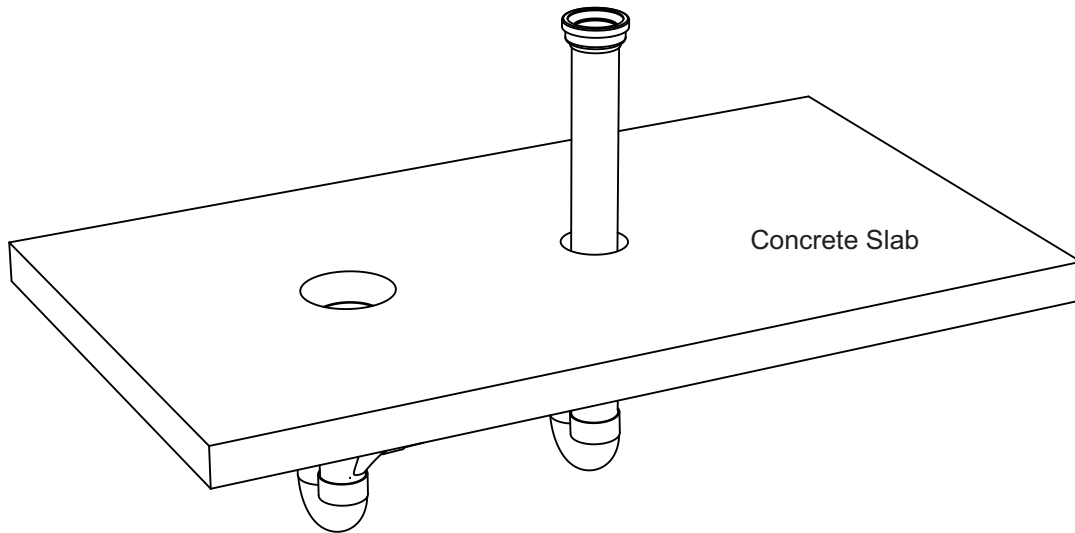

**Important**  All Plumbing & Installation shall be in accordance with AS/NZS 3500.2 Sanitary Plumbing and Drainage Standard

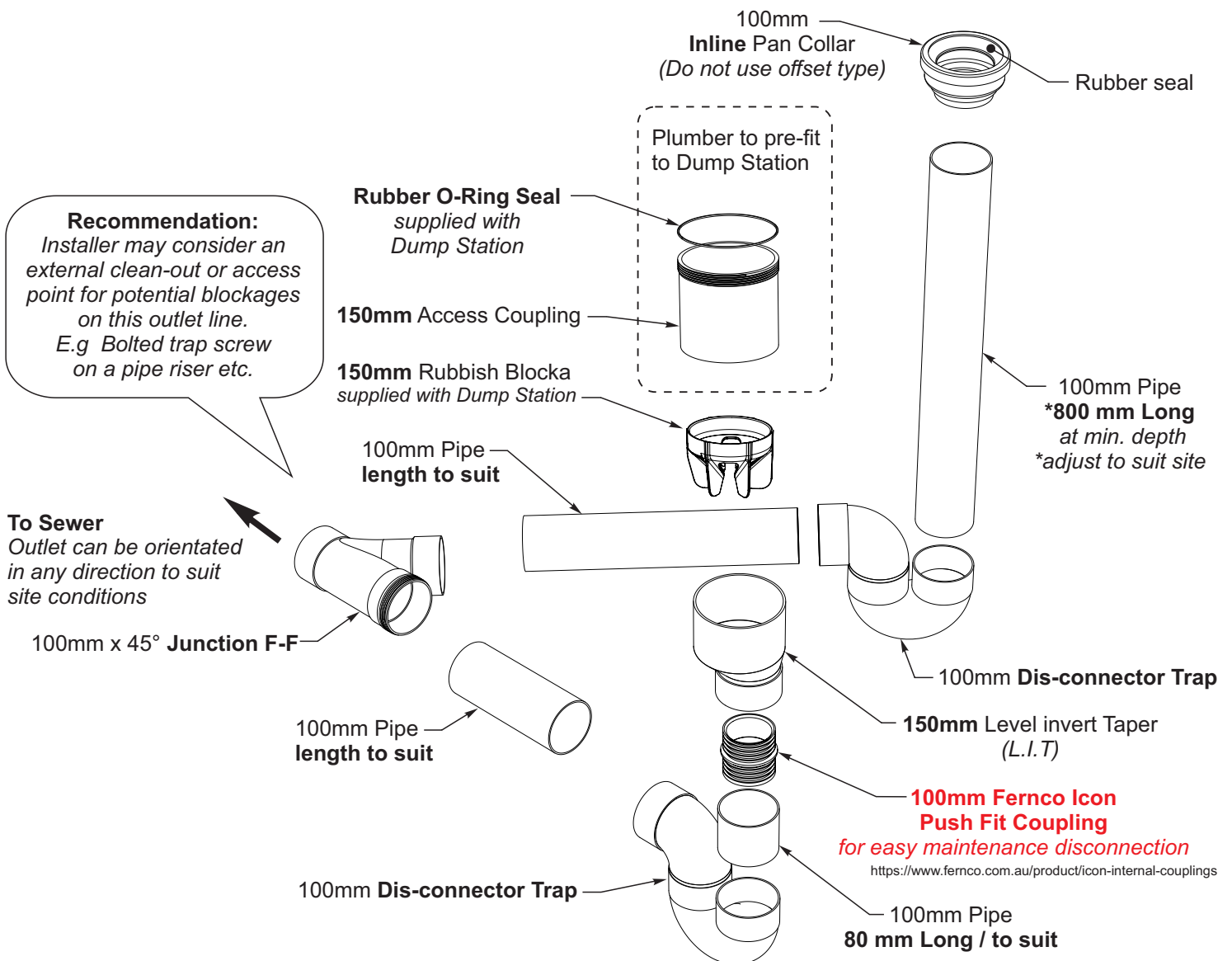

**All Plumbing shall be 100mm DWV PVC-U unless noted otherwise**

# Plumbing & Concrete Slab Set-up - Double trap (shallow depth)

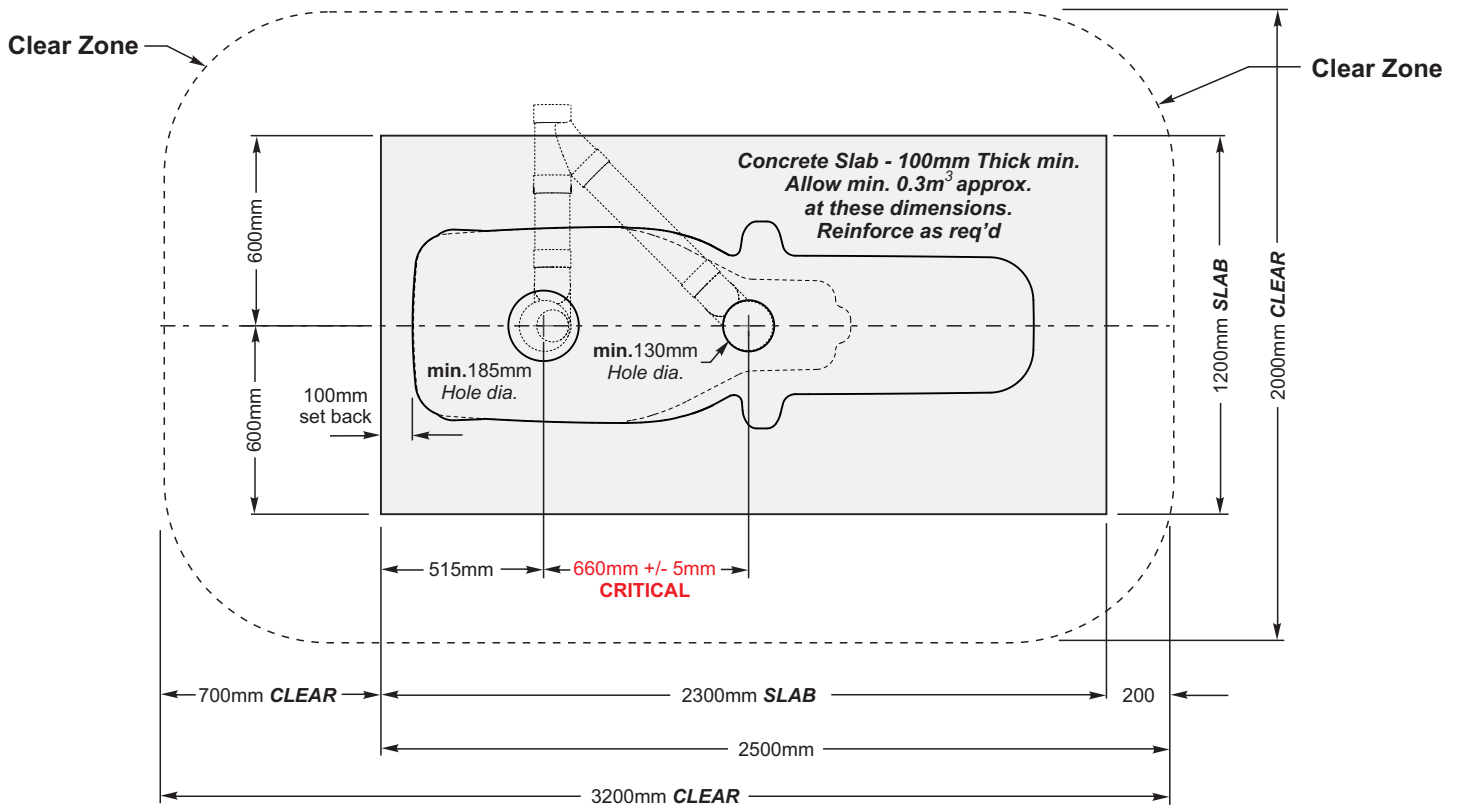

**Top View**

**Very Important** ⚠

Form an oversized hole in the concrete around the Lever Invert Taper leaving clearance for the 150mm coupling to fit down the outside when the Dump Station is lowered into position. E.g wrap foam tape or a larger pipe offcut etc to form gap from concrete.

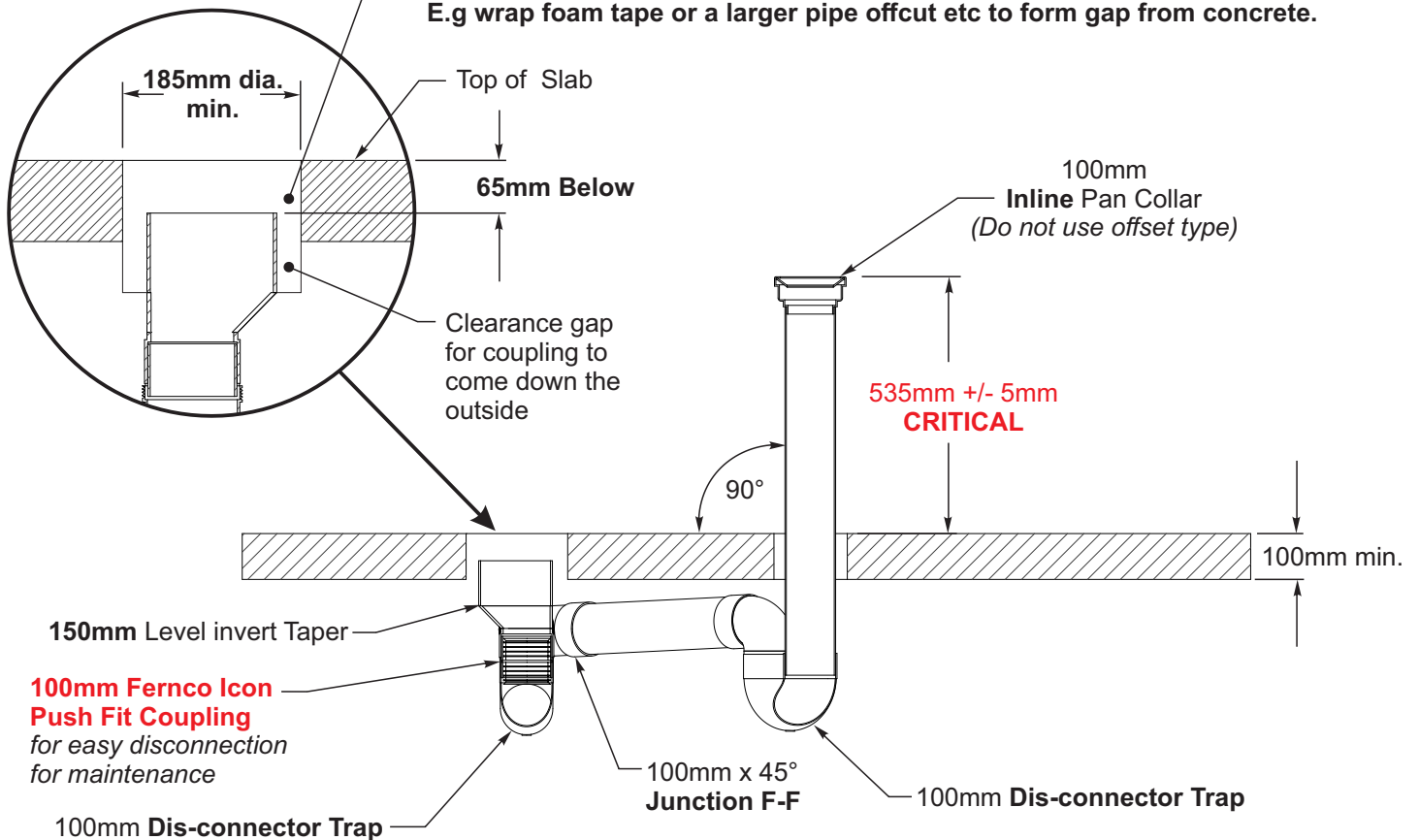

**Cross Section**



## Pre-fitting the O-Ring & Coupling

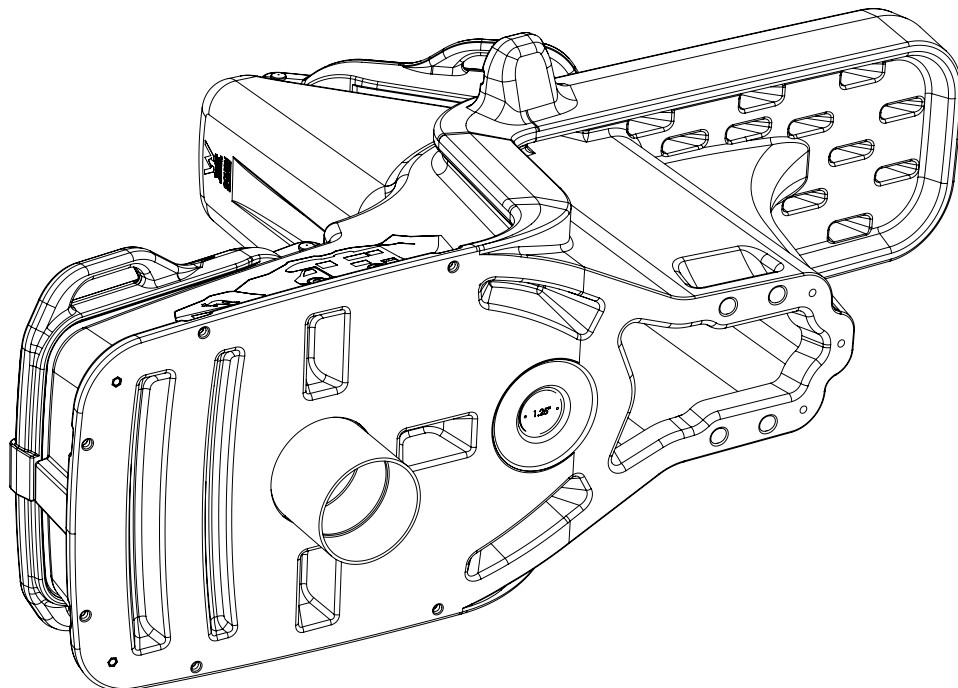
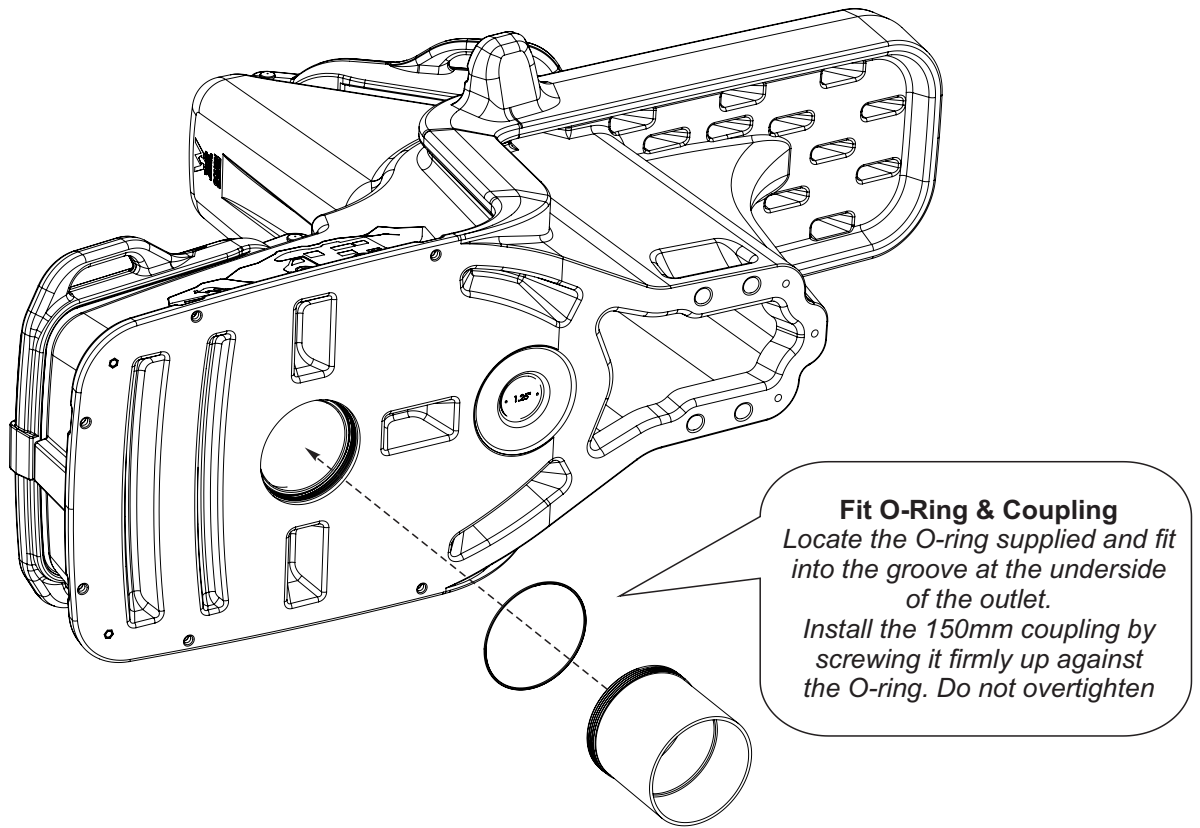

**O-Ring & Coupling fitted ready  
for installation**

# Installing the Dump Station

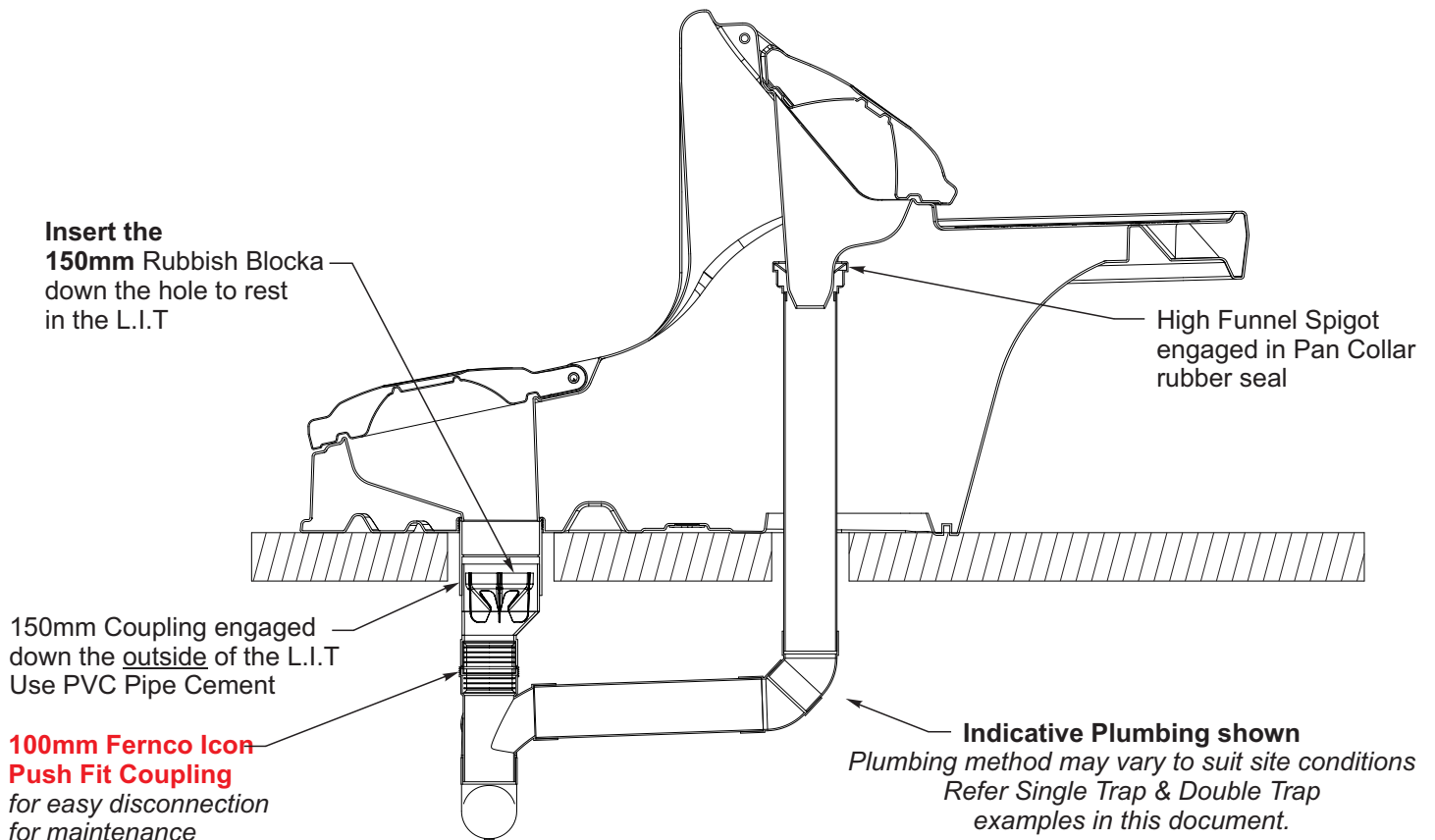
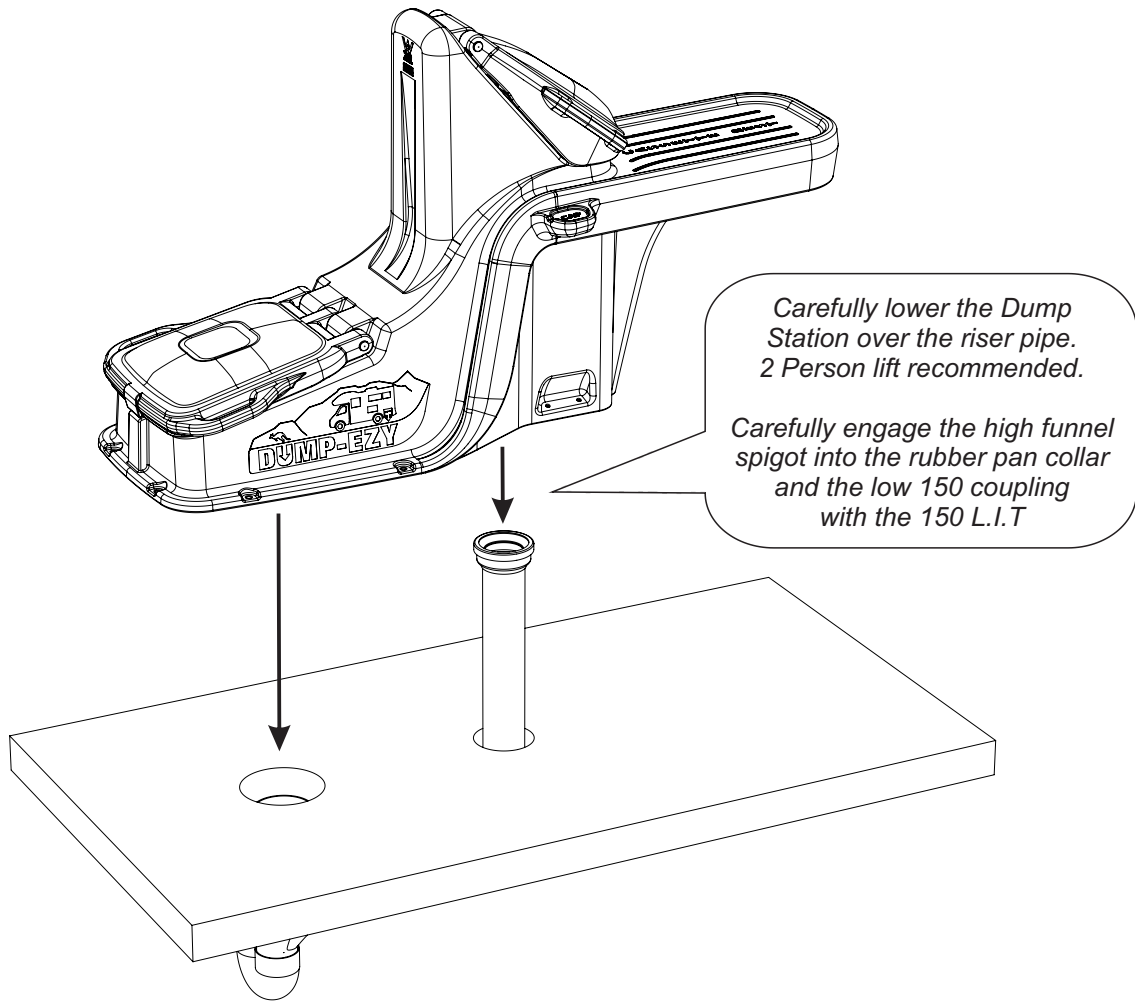

# Fixing Down

Fix the unit into position using Stainless steel Fasteners.

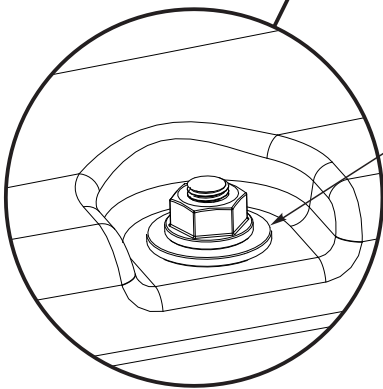
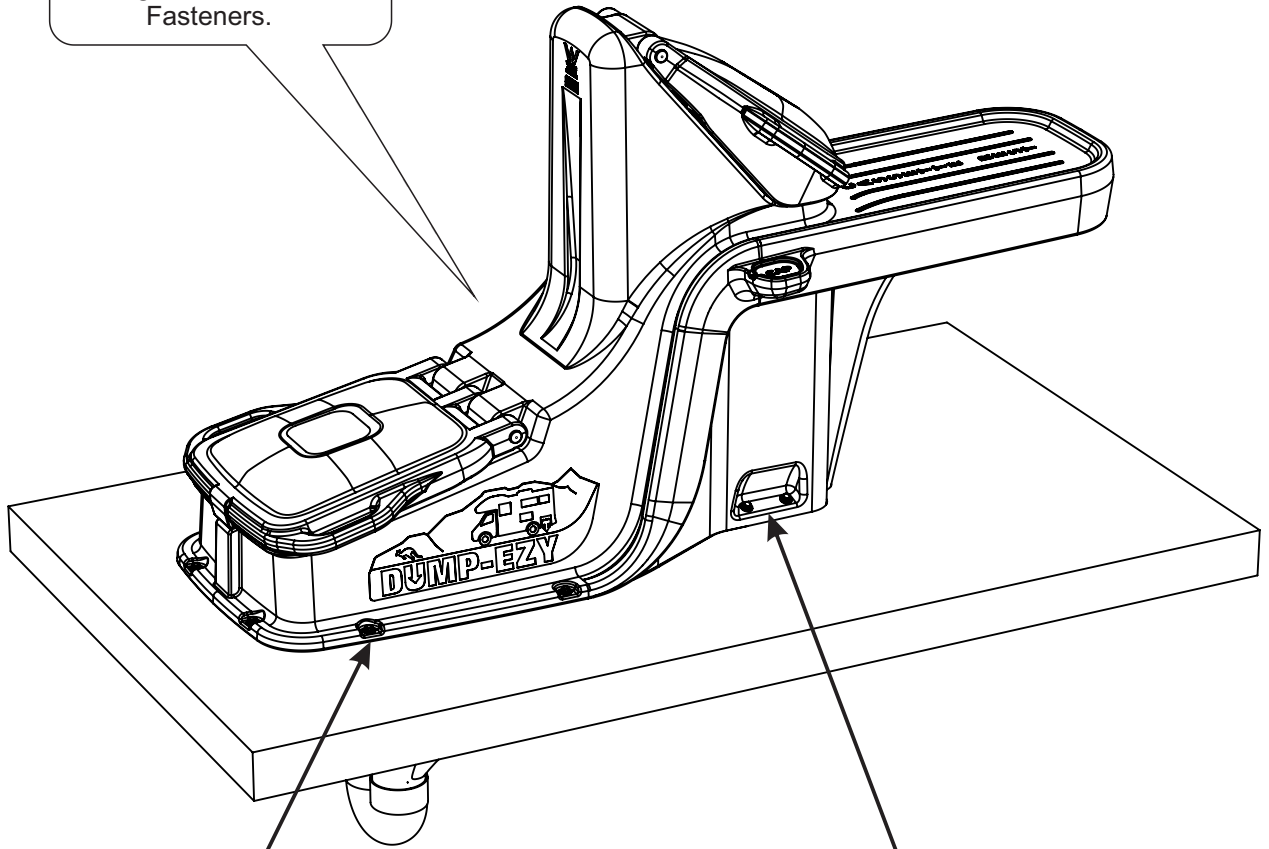

M12 SS Washers

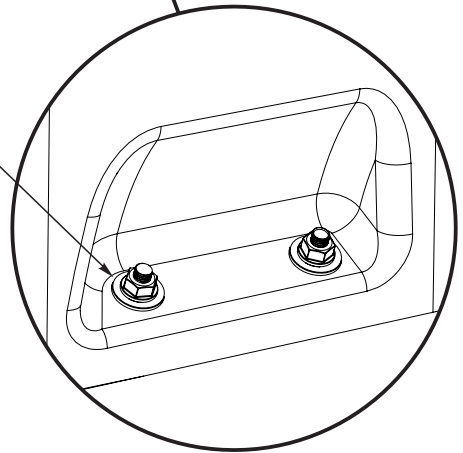

M10 x 90mm Concrete Anka Screws - Stainless Steel  
NB: M10 x 75mm can be used here as alternative.

Qty: 6

M10 x 90mm Concrete Anka Screws - Stainless Steel  
NB: M10 x 100mm can be used here as alternative.

Qty: 4

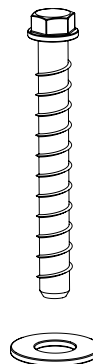

Use M12 Stainless Washer with M10 Concrete Anka Screws  
NB: M10 Washer will not fit M10 Anka Screw.

# Example Installation



**Double Trap Option**  
connecting to shallow inlet on  
existing Septic Tank



**100mm Pan Collar (Inline)**  
Must use Inline type.  
*Do not use offset type.*



**Form work (piece of bucket)**  
To allow clearance for 150mm  
coupling to lower down into  
slab after slab is poured.



**100mm Fernco  
Push Fit Coupling**  
For easy disconnection.



**100mm Fernco  
Push Fit Coupling**  
Allows unit to be unbolted and  
easily lifted up if access to  
the plumbing is ever required  
for maintenance. eg. a blockage  
*If PVC L.I.T is solvent glued  
you cannot remove the unit  
without breaking the plumbing.*



**100mm Coupling & O-ring**  
O-ring fitted and coupling  
threaded in before lowering  
unit down on coupling

# Example Installation



**Fit Check**  
*Prior to pouring concrete*



**100mm Fernco Push Fit Coupling**  
*For easy disconnection.  
For maintenance.*

**Non Potable Water Tap**  
*For wash down hose*



**Option to use Rubber Fernco Plumbqwik**  
*If there is any misalignment issue.*



# Usage Instructions

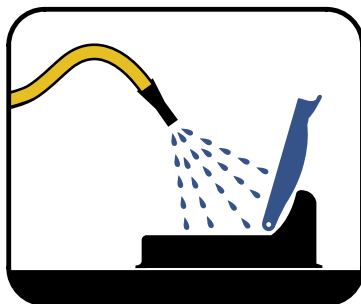

**Wash Down**

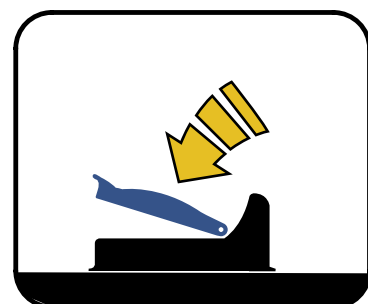

**Close the Lids**

# Maintenance & Cleaning

## Construction

The unit is rotationally moulded from tough UV stabilised, non-corroding polyethylene.

## Maintenance and Cleaning

The use of harsh abrasive anti-bacterial toilet cleaners is not recommended.

The Dump-Ezy Dump Station can be an entry point for a waste treatment system, which is a living biological process.

Anti-bacterial and strong chemical cleaners have the potential to kill or severely reduce the effectiveness of the living treatment system if poured into the unit.

The surface of the Dump-Ezy unit should only be cleaned with no-abrasive cleaning products as follows.

## Cleaning Method

The Dump-Ezy should be cleaned at least twice weekly with a soft brush and a Septic safe cleaning product.

We recommend using a product called EMC by VRM which is available from Tradelink Plumbing supplies.

Mix EMC in the ration of 1:10 into half a bucket of water. Scrub all over the Dump-ezy surface with a soft brush to remove all soiling. If required use the concentrated EMC to remove stubborn soiling.

Wash down the outside fo the Dump-Ezy with the same product.

Any remaining mixed cleaning product may be tipped down the waste. Hose down the general area.

## Sludge Management

If you Dump-Ezy is connected to a septic tank, you will need to monitor the sludge level in the tank.

A sludge gauge can be used to determine when the disposal is required and a regular interval can be established if usage is reasonably regular.

## Questions

Please contact Gough Plastics on Free call 1800 069 805 (International +61 7 4758 6400 or your local Agent.

Website - [www.gough.com.au/dump-ezy/default.htm](http://www.gough.com.au/dump-ezy/default.htm)